



# o.e.m. service bulletin

TO: PURCHASING  INSTALLERS   
ENGINEERING

No. 96-14

## Bravo Drives and Transoms

### Models

4.3LX Gen+ / 4.3LXH Gen+ / 5.7L 2 Barrel / 5.7LX / 7.4L  
5.7L EFI / 5.7LX EFI / 5.7LX EFI Gen+ / 7.4LX EFI / 7.4LX MPI  
262 Magnum EFI Gen+ / 350 Magnum / 350 Magnum EFI Gen+  
350 Magnum MPI Gen+ / 454 Magnum / 454 Magnum MPI  
502 Magnum MPI / D2.8L D-Tronic / D3.6L / D4.2L / D4.2L D-Tronic

### Change

1997 Bravo Drive Unit and Transom Assemblies with an end model code of (KS) may be used with the 1997<sup>1/2</sup> Bravo Drive Unit and Transom Assemblies with an end model code of (KT) with the following changes.

### Description

The new design Bravo Drive shaft housing has the Trim-In limit functions (utilized with the Bravo Three Drive) located at the aft anchor pin hole location as shown below. Prior models utilized the (A and B) Trim-In limit blocks that were attached to the front anchor pin on the transom assembly. The bell housing has also been changed on the 1997<sup>1/2</sup> transom assembly. The change allows for clearance between the bell housing and the gimbal ring "U" bolt when the drive is in the trailer position. The Trim-In limit spacer, Part Number **808006**, is packed in the shipping box along with the Bravo Drive unit. The spacer can simply be pushed into the rear anchor pin slot by hand.

### Usage

When installing a 1997<sup>1/2</sup> Bravo Three drive with an end model code of (KT) on a matching transom assembly with an end model code of (KT), place the Trim-In limit spacer in the aft most position of the rear anchor pin slot as shown below. **DO NOT** use Trim-In limit blocks with this application.

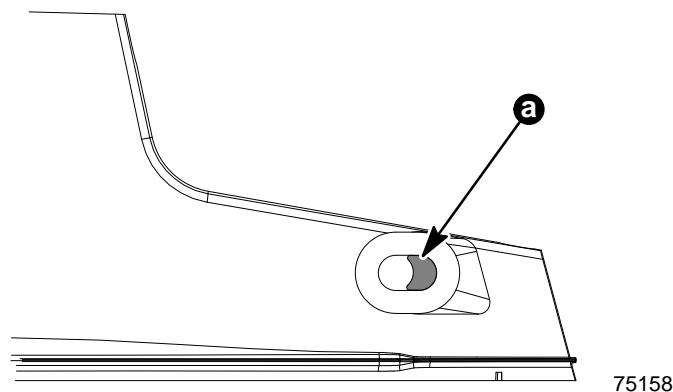

a - Trim-In Limit Spacer Location

The 1997<sup>1/2</sup> transom assembly is identified by two relief grooves cast into the top of the bell housing to allow for clearance of the gimbal ring "U" bolt. As shown below.

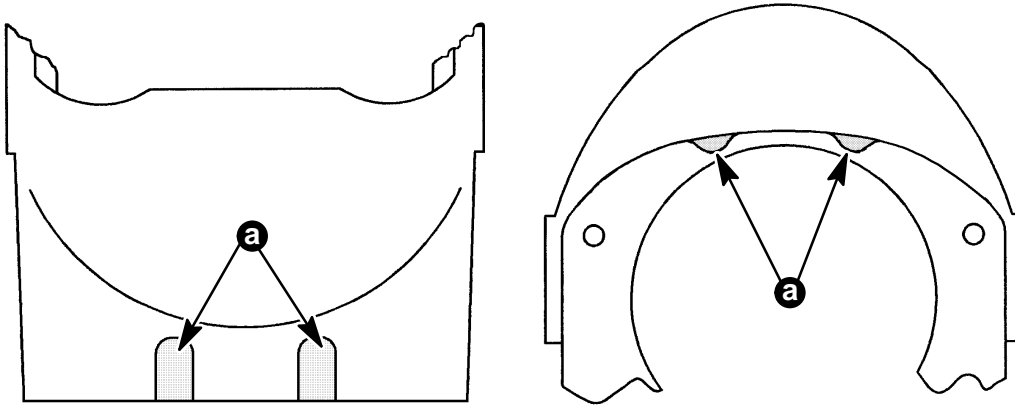

75364

a - Relief Grooves

To install a 1997<sup>1/2</sup> Bravo One or Bravo Two drive unit, with an end model code of (KT), on a 1997 (KS) or a 1997<sup>1/2</sup> (KT) transom assembly, place the Trim-In limit spacer in the front location of the aft trim cylinder pin slot. As shown below.

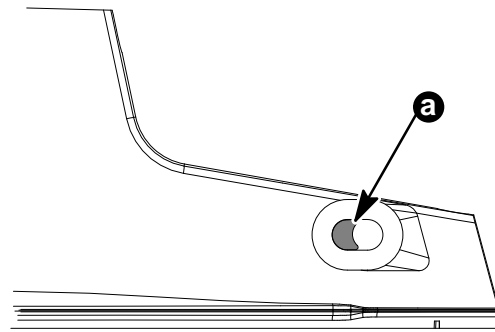

75157

a - Trim-In Limit Spacer Location

To install a 1997<sup>1/2</sup> Bravo Three with an end model code of (KT) on a 1997 transom assembly with an end model code of (KS) place the Trim-In limit spacer in the most forward position of the trim cylinder anchor pin slot, as shown below. This installation also requires the **806692A2** (A and B) Trim-In limit blocks to be installed on the front trim cylinder anchor pin on the gimbal ring. This will limit the Trim-In range of the drive. The blocks must be installed with the letters (A and B) facing up towards the gimbal ring.

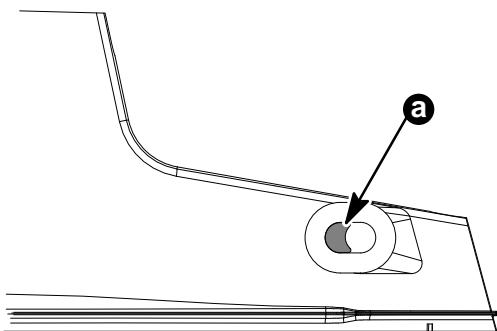

75157

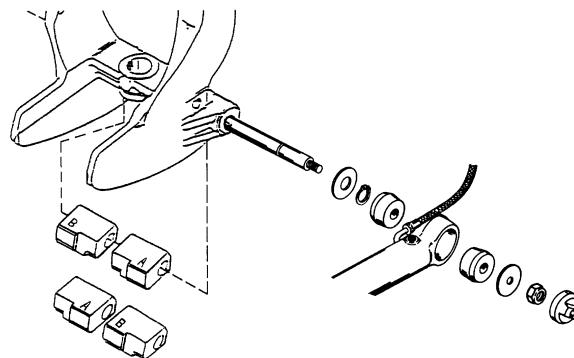

74516

a - Trim-In Limit Spacer Location